

AMP / AMT / AMZ / TX - PRESSURE GAUGES

Name	Number of scales	Measurement range	Scale division	Piston diameter mm	Piston area cm ²	A mm	B mm	C mm	D mm	E mm
AMP651	5	-40 kN	2 kN	30 45 65	7 16 33	G 1/2"	137	45	100	18
		-100 kN	10 kN							
		-200 kN	10 kN							
		-70 MPa	2 MPa							
		-10000 psi	500 psi							
AMP652	5	-400 kN	20 kN	90 110 140	64 95 154	G 1/2"	137	45	100	18
		-600 kN	50 kN							
		-1000 kN	50 kN							
		-70 MPa	2 MPa							
		-10000 psi	500 psi							
AMT650	2	-100 MPa	2 MPa			G 1/2"	137	45	100	18
		-14000 psi	500 psi							
AMT151	2	-160 MPa	5 MPa			M20x1,5	76,5	45	112	24
		-23000 psi	500 psi							
AMT301	2	-310 MPa	10 MPa			M20x1,5	76,5	45	112	24
		-45000 psi	1000 psi							
AMT801	2	-100 MPa	5 MPa			G 1/4"	50	28,5	60	15
		-15000 psi	1000 psi							
AMZ100	1	-1000 kN	50 kN	140	154	G 1/2"	137	45	100	18
AMZ50	2	-500 kN	20 kN	100	79	G 1/2"	137	45	100	18
		-50 ton								
AMZ150	2	-17 ton	1 ton	55	23,7	G 1/2"	137	45	100	18
		-700 bar	20 bar							
AMZ250	2	-24 ton	1 ton	65	33,1	G 1/2"	137	45	100	18
		-700 bar	20 bar							
TX102	3	-4 ton	1 ton	30 45	7 16	G 3/8"	130	45	100	18
		-10 ton	1 ton							
		-600 bar	50 bar							
TX103*	1	-160 MPa	5 MPa			G 1/4"	50	30	66	10,5
TX104*	2	-160 MPa	5 MPa			G 1/4"	50	30	62	9
		-20000 psi	1000 psi							

* TX103 & TX104 can be connected directly on standard hand pumps within the PHS-serien. Gauge adaptor not required!

AMT151
AMT301
AMT801
TX103
TX104

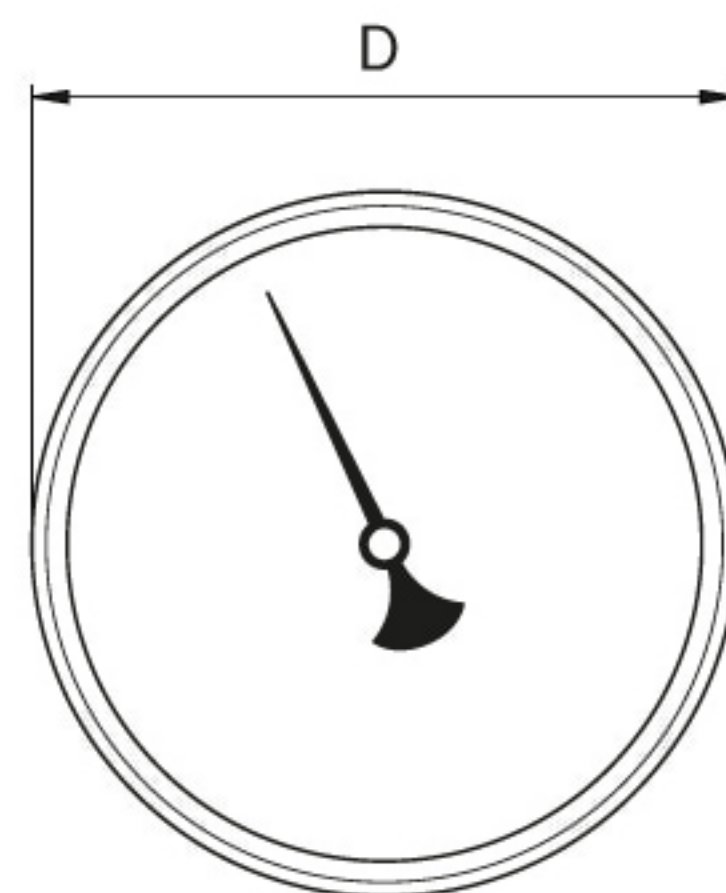
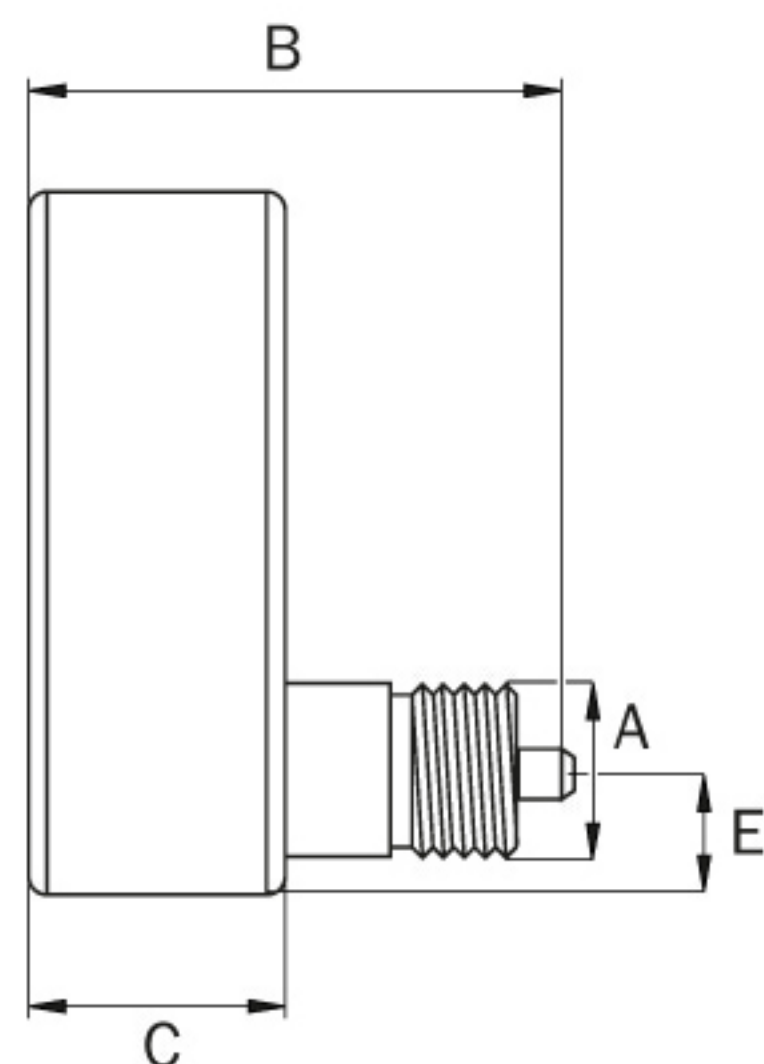

AMP651
AMP652
AMT650
AMZ100
AMZ50
AMZ150
AMZ250
TX102

