

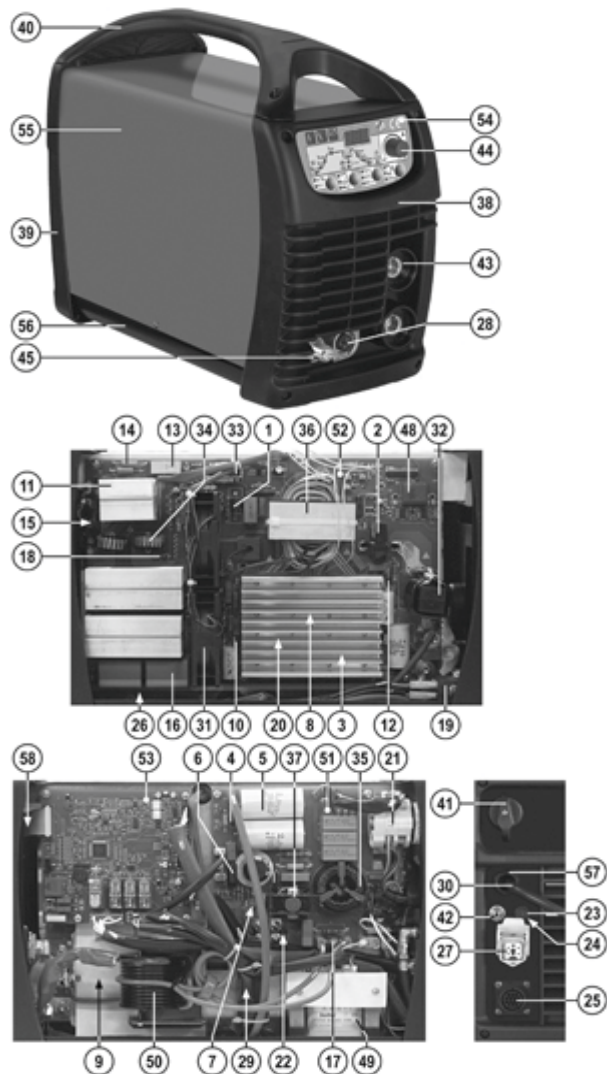

näsström maskin

# 816119 SUPERIOR TIG 252 AC/DC HF/LIFT VRD AQUA

Datum: 2016-05-24



Ref.	Description	Key	Ref.	Description	Key
1	IGBT	111095	34	INDUCTANCE	169746
2	SENSOR HALL	111191	35	FILTER INDUCTOR	169747
3	IGBT	111193	36	POWER TRAFO	169789
4	DIODE	112689	37	TRASFO FLYBACK HF	169795
5	COND.MKP ASS. 5U 700V C4G	112895	38	FRONT PANEL	321117
6	SINGLE-PHASE RECTIFIER	112949	39	BACK PANEL	321118
7	DIODE BY228 3A 1500V	113072	40	HANDLE	321119
8	DIODE	113747	41	SWITCH KNOB SET	323101
9	RESISTANCE	116443	42	PIPE FITTING	602052
10	DIODE	116486	43	DINSE SOCKET DX 50	712036
11	SINGLE PHASE BRIDGE	111259	44	POTENTIOMETER KNOB	121547
12	VOLTAGE SUPPRESSOR	116733	45	GAS PIPE CONNECTOR KIT	980548
13	RELAIS 24VDC 17MA 250V 16A 1NO	116738	46	IGBT + DIODE KIT	981370
14	RESISTANCE	116752	47	KIT IGBT + PULSE TRANSFORMER	981371
15	VARISTOR	116760	48	KIT PULSE TRANSFORMER	981372
16	CONDENSER	116882	49	AUXILIARY TRANSFORMER KIT	981401
17	GAS DISCHARGER 400V	116904	50	HF TRANSFORMER KIT	981402
18	RESISTANCE 10R 2W 5% FUSE	116962	51	FILTER CARD KIT	981403
19	ELECTROVALVE	121029	52	POWER BOARD KIT	981404
20	THERMAL SWITCH	121261	53	CONTROL CARD KIT	981405
21	SWITCH	121556	54	KEYPAD CARD KIT	981406
22	IGBT 50A 1200V SOT227	111197	55	COVER KIT	981407
23	FUSE HOLDER	122159	56	BOTTOM KIT	981408
24	FUSE	122437	57	KIT CABLE BUSHING + RING NUT	990046
25	CONTROL CABLE/C.A.D.	124105	58	KIT FRONT PANEL CARD	981535
26	RESISTANCE CABLE	124656			
27	G.R.A. CABLE	124657			
28	TORCH BUTTON CABLE	124658			
29	FAN CABLE	124668			
30	MAINS CABLE 4G1.5 2 M	132237			
31	FAN	152269			
32	INDUCTANCE	169556			
33	TRANSFORMATEUR COMPLET	169627			



näsström maskin

# 816119 SUPERIOR TIG 252 AC/DC HF/LIFT VRD AQUA

Datum: 2016-05-24

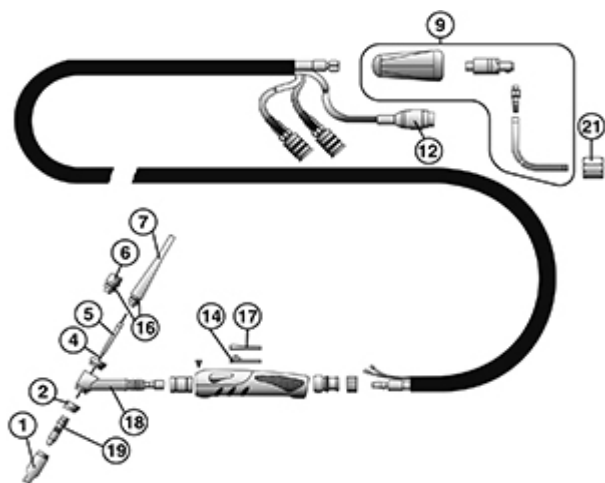

Ref.	Description	Key	Ref.	Description	Key
1	KIT 10 CERAMIC NOZZLES NR.6	802245	16	OR RING	722061
1	KIT 10 CERAMIC NOZZLES NR.10	802248	17	PUSHBOTTON	742042
1	KIT 10 CERAMIC NOZZLES NR.7	802246	18	TORCH BODY	742047
1	KIT 10 CERAMIC NOZZLES NR.8	802247	19	KIT 3 ELECTRODE DIFFUSERS D.2,4 MM	802251
2	INSULATOR	722248	19	KIT 3 ELECTRODE DIFFUSERS D.4 MM	802253
4	KIT 10 PURE TUNGSTEN ELECTR. D.2,4 MM	802236	19	KIT 3 ELECTRODE DIFFUSERS D.1,6 MM	802250
4	KIT 10 PURE TUNGSTEN ELECTR. D.1,6 MM	802235	19	KIT 3 ELECTRODE DIFFUSERS D.3,2 MM	802252
4	KIT 10 CERIUM-TUNGSTEN ELECTR. D.1,6 MM	802222	21	3/8" CONNECTION KIT TIG TORCH	990263
4	KIT 10 PURE TUNGSTEN ELECTR. D.3,2 MM	802237			
4	KIT 10 CERIUM-TUNGSTEN ELECTR. D.3,2 MM	802233			
4	KIT 10 CERIUM-TUNGSTEN ELECTR. D.2,4 MM	802232			
4	KIT 10 PURE TUNGSTEN ELECTR. D. 4 MM	802238			
5	KIT 3 ELECTRODE HOLDER CLAMPS D.3,2 MM	802242			
5	KIT 3 ELECTRODE HOLDER CLAMPS D.1,6 MM	802240			
5	KIT 3 ELECTRODE HOLDER CLAMPS D.4 MM	802243			
5	KIT 3 ELECTRODE HOLDER CLAMPS D.2,4 MM	802241			
6	SHORT CAP	722192			
7	LONG CAP	722193			
9	DINSE 50 CONNECTION KIT	981443			
12	5P PLUG	742599			
14	PUSHBOTTON CONTACT	452089			