

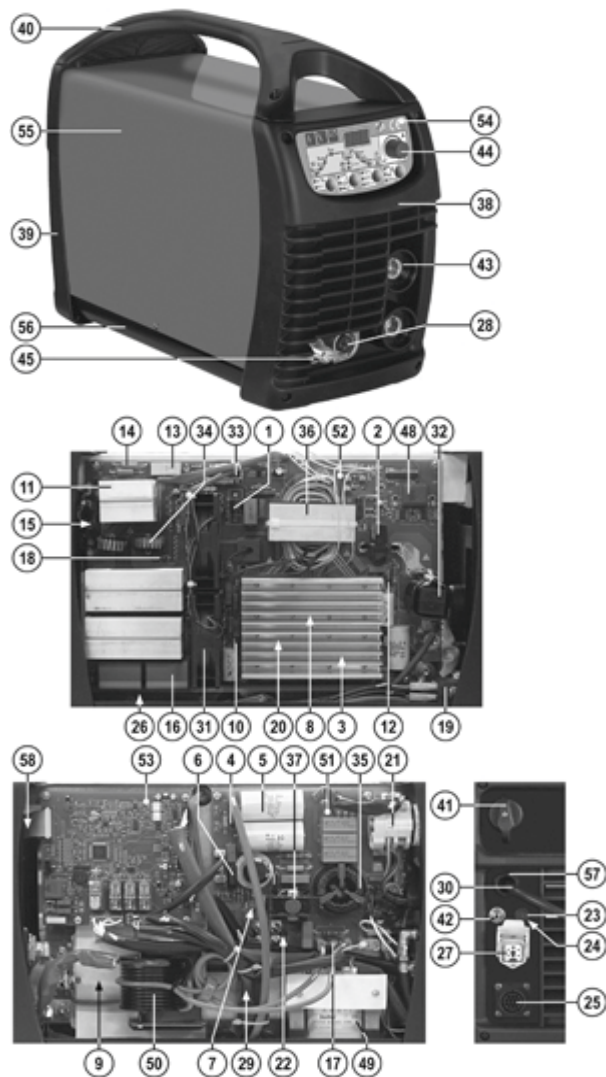

SUPERIOR TIG 252AC/DC HF/LIFT VRD 400V+A



| Ref. | Description | Key |
|------|--------------------------------|--------|
| 1 | IGBT | 111095 |
| 2 | SENSOR HALL | 111191 |
| 3 | IGBT | 111193 |
| 4 | DIODE | 112689 |
| 5 | COND.MKP ASS. 5U 700V C4G | 112895 |
| 6 | SINGLE-PHASE RECTIFIER | 112949 |
| 7 | DIODE BY228 3A 1500V | 113072 |
| 8 | DIODE | 113747 |
| 9 | RESISTANCE | 116443 |
| 10 | DIODE | 116486 |
| 11 | SINGLE PHASE BRIDGE | 111259 |
| 12 | VOLTAGE SUPPRESSOR | 116733 |
| 13 | RELAIS 24VDC 17MA 250V 16A 1NO | 116738 |
| 14 | RESISTANCE | 116752 |
| 15 | VARISTOR | 116760 |
| 16 | CONDENSER | 116882 |
| 17 | GAS DISCHARGER 400V | 116904 |
| 18 | RESISTANCE 10R 2W 5% FUSE | 116962 |
| 19 | ELECTROVALVE | 121029 |
| 20 | THERMAL SWITCH | 121261 |
| 21 | SWITCH | 121556 |
| 22 | IGBT 50A 1200V SOT227 | 111197 |
| 23 | FUSE HOLDER | 122159 |
| 24 | FUSE | 122437 |
| 25 | CONTROL CABLE/C.A.D. | 124105 |
| 26 | RESISTANCE CABLE | 124656 |
| 27 | G.R.A. CABLE | 124657 |
| 28 | TORCH BUTTON CABLE | 124658 |
| 29 | FAN CABLE | 124668 |
| 30 | MAINS CABLE 4G1.5 2 M | 132237 |
| 31 | FAN | 152269 |
| 32 | INDUCTANCE | 169556 |
| 33 | TRANSFORMATEUR COMPLET | 169627 |

| Ref. | Description | Key |
|------|------------------------------|--------|
| 34 | INDUCTANCE | 169746 |
| 35 | FILTER INDUCTOR | 169747 |
| 36 | POWER TRAFO | 169789 |
| 37 | TRASFO FLYBACK HF | 169795 |
| 38 | FRONT PANEL | 321117 |
| 39 | BACK PANEL | 321118 |
| 40 | HANDLE | 321119 |
| 41 | SWITCH KNOB SET | 323101 |
| 42 | PIPE FITTING | 602052 |
| 43 | DINSE SOCKET DX 50 | 712036 |
| 44 | POTENTIOMETER KNOB | 121547 |
| 45 | GAS PIPE CONNECTOR KIT | 980548 |
| 46 | IGBT + DIODE KIT | 981370 |
| 47 | KIT IGBT + PULSE TRANSFORMER | 981371 |
| 48 | KIT PULSE TRANSFORMER | 981372 |
| 49 | AUXILIARY TRANSFORMER KIT | 981401 |
| 50 | HF TRANSFORMER KIT | 981402 |
| 51 | FILTER CARD KIT | 981403 |
| 52 | POWER BOARD KIT | 981404 |
| 53 | CONTROL CARD KIT | 981405 |
| 54 | KEYPAD CARD KIT | 981406 |
| 55 | COVER KIT | 981407 |
| 56 | BOTTOM KIT | 981408 |
| 57 | KIT CABLE BUSHING + RING NUT | 990046 |
| 58 | KIT FRONT PANEL CARD | 981535 |



SUPERIOR TIG 252AC/DC HF/LIFT VRD 400V+A

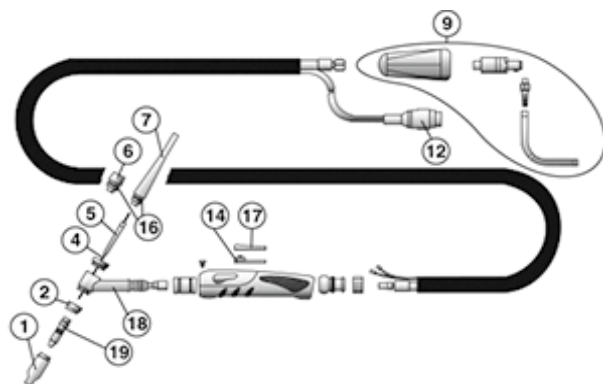

| Ref. | Description | Key | Ref. | Description | Key |
|------|---|--------|------|------------------------------------|--------|
| 0 | TORCH 4 M | 722559 | 17 | PUSHBOTTON | 742042 |
| 1 | KIT 10 CERAMIC NOZZLES NR.6 | 802245 | 18 | TORCH BODY | 722944 |
| 1 | KIT 10 CERAMIC NOZZLES NR.10 | 802248 | 19 | KIT 3 ELECTRODE DIFFUSERS D.1,6 MM | 802250 |
| 1 | KIT 10 CERAMIC NOZZLES NR.4 | 802244 | 19 | KIT 3 ELECTRODE DIFFUSERS D.4 MM | 802253 |
| 1 | KIT 10 CERAMIC NOZZLES NR.7 | 802246 | 19 | KIT 3 ELECTRODE DIFFUSERS D.3,2 MM | 802252 |
| 1 | KIT 10 CERAMIC NOZZLES NR.8 | 802247 | 19 | KIT 3 ELECTRODE DIFFUSERS D.1 MM | 802249 |
| 2 | INSULATOR | 722248 | 19 | KIT 3 ELECTRODE DIFFUSERS D.2,4 MM | 802251 |
| 4 | KIT 10 CERIUM-TUNGSTEN ELECTR. D.3,2 MM | 802233 | | | |
| 4 | KIT 10 PURE TUNGSTEN ELECTR. D.3,2 MM | 802237 | | | |
| 4 | KIT 10 PURE TUNGSTEN ELECTR. D. 4 MM | 802238 | | | |
| 4 | KIT 10 CERIUM-TUNGSTEN ELECTR. D.1 MM | 802220 | | | |
| 4 | KIT 10 PURE TUNGSTEN ELECTR. D.1,6 MM | 802235 | | | |
| 4 | KIT 10 CERIUM-TUNGSTEN ELECTR. D.1,6 MM | 802222 | | | |
| 4 | KIT 10 CERIUM-TUNGSTEN ELECTR. D.2,4 MM | 802232 | | | |
| 4 | KIT 10 PURE TUNGSTEN ELECTR. D.2,4 MM | 802236 | | | |
| 5 | KIT 3 ELECTRODE HOLDER CLAMPS D.3,2 MM | 802242 | | | |
| 5 | KIT 3 ELECTRODE HOLDER CLAMPS D.4 MM | 802243 | | | |
| 5 | KIT 3 ELECTRODE HOLDER CLAMPS D.1,6 MM | 802240 | | | |
| 5 | KIT 3 ELECTRODE HOLDER CLAMPS D.2,4 MM | 802241 | | | |
| 5 | KIT 3 ELECTRODE HOLDER CLAMPS D.1,0 MM | 802239 | | | |
| 6 | SHORT CAP | 722192 | | | |
| 7 | LONG CAP | 722193 | | | |
| 9 | DINSE 50 CONNECTION KIT | 981443 | | | |
| 12 | 5P PLUG | 742599 | | | |
| 14 | PUSHBOTTON CONTACT | 452089 | | | |
| 16 | OR RING | 722061 | | | |