

852031

Technology Tig 222

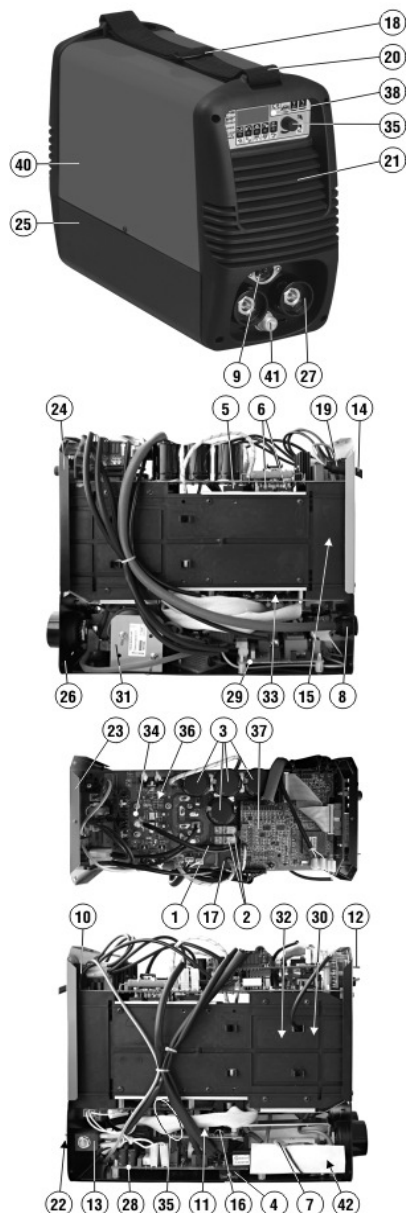

Ref.	Description	Key
1	RESISTANCE	112048
2	RELAIS	112342
3	CAPACITOR	112514
4	SCR	113585
5	RECTIFIER	116346
6	IGBT	116521
7	CAPACITOR	120176
8	CONTROL CABLE	120513
9	SOCKET CABLE	120514
10	SWITCH	121007
11	THERMOSTAT	121342
13	ELECTROVALVE	122035
14	MAINS CABLE 3G2.5 2 M	132158
15	FAN	152214
16	SHUNT	152219
17	CURRENT TRANSFORMER	152230
18	BELT BUCKLE	322065
19	CABLE BUSHING	322112
20	BELT	322408
21	FRAME	322508
22	PIPE FITTING	602052
23	BACK PANEL	638704
24	FRONT PANEL	644884
25	BOTTOM KIT	980931
26	BOTTOM	645346
27	DINSE SOCKET DX 50	712036
28	H.F. CARD KIT	980467
29	TORCH PUSHBUTTON CARD KIT	980472
30	POWER TRANSFORMER KIT	980509
31	HF TRANSFORMER KIT	980510
32	OUTPUT INDUCTANCE KIT	980511
33	3 DIODES KIT	980512
34	PRIMARY PCB KIT	980515
35	SECONDARY PCB KIT	980516
36	DIODES-IGBT-RES. KIT	980517
37	CONTROL BOARD KIT	980518

Ref.	Description	Key
38	FRONT PANEL + CARD SET	980519
39	ENCODER KNOB KIT	980520
40	COVER KIT	980521
41	GAS PIPE CONNECTOR KIT	990120
42	KIT SUPPORT CONTROL PCB	990764
43	CABLE 25 MMQ 3 M	123467
44	ARGON GAS BOTTLE IT ADAPTOR	432036
45	DINSE PLUG DX 50	712040
46	TOLEDO 300A WORK CLAMP	712231
47	GAS REGULATOR 2 MANOMETERS	722119
48	ST26 TIG TORCH 4 M 220 A	742427

852031

Technology Tig 222

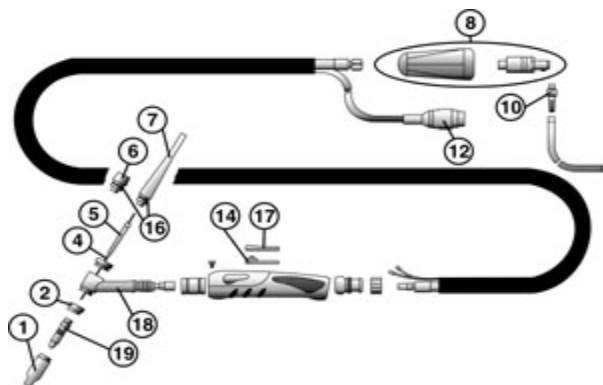

Ref.	Description	Key
1	KIT 10 CERAMIC NOZZLES NR.7	802246
1	KIT 10 CERAMIC NOZZLES NR.6	802245
1	KIT 10 CERAMIC NOZZLES NR.8	802247
1	KIT 10 CERAMIC NOZZLES NR.10	802248
2	INSULATOR	722248
4	KIT 10 PURE TUNGSTEN ELECTRODES D.1,6	802235
4	KIT 10 PURE TUNGSTEN ELECTRODES D.4	802238
4	KIT 10 CERIUM-TUNGSTEN ELECTR. D.1,6 MM	802222
4	KIT 10 PURE TUNGSTEN ELECTRODES D.3,2	802237
4	KIT 10 CERIUM-TUNGSTEN ELECTR. D.3,2 MM	802233
4	KIT 10 CERIUM-TUNGSTEN ELECTRODES D.1 MM	802220
4	KIT 10 CERIUM-TUNGSTEN ELECTR. D.2,4 MM	802232
4	KIT 10 PURE TUNGSTEN ELECTRODES D.2,4	802236
5	KIT 3 ELECTRODE HOLDER CLAMPS Ø 1,0 MM	802239
5	KIT 3 ELECTRODE HOLDER CLAMPS Ø 4,0 MM	802243
5	KIT 3 ELECTRODE HOLDER CLAMPS Ø 1,6 MM	802240
5	KIT 3 ELECTRODE HOLDER CLAMPS Ø 2,4 MM	802241
5	KIT 3 ELECTRODE HOLDER CLAMPS Ø 3,2 MM	802242
6	SHORT CAP	722192

Ref.	Description	Key
7	LONG CAP	722193
8	DINSE CONNECTION 50 MMQ	712893
10	GAS CLUTCH CONNECTOR	722292
12	3P PLUG	722999
14	PUSHBOTTON CONTACT	452089
16	OR RING	722061
17	PUSHBOTTON	742042
18	TORCH BODY	722944
19	KIT 3 ELECTRODE DIFFUSERS Ø 3,2 MM	802252
19	KIT 3 ELECTRODE DIFFUSERS Ø 2,4 MM	802251
19	KIT 3 ELECTRODE DIFFUSERS Ø 1,6 MM	802250
19	KIT 3 ELECTRODE DIFFUSERS Ø 4,0 MM	802253
19	KIT 3 ELECTRODE DIFFUSERS Ø 1,0 MM	802249